

DAILY NEWS

April 23, 2015

NoHo penthouse has a sense of history and modern flash



BY KATHERINE
CLARKE

NEW YORK DAILY NEWS / Wednesday, April 22, 2015, 5:06 PM

AAA



It might not be an original, but it sure isn't a cheap knockoff. A palatial NoHo penthouse slated to hit the market at \$25 million offers prospective buyers the chance to own a slice of New York City's architectural history in the form of a decorative Queen Anne-style pediment.

The 4,480-square-foot apartment sits within the pediment, a triangular archway crowning the building, making for the ultimate statement pad.

What's the catch? The pediment isn't actually the original, which years ago fell off the Civil War-era building, known as the Schumacher, at 36 Bleecker St. Instead it's an extremely accurate replica, constructed using historic photos and old construction proposals.

Developer Roy Stillman learned about the building's former architectural flourish after coming across an old photograph, and commissioned architects to re-create its look.

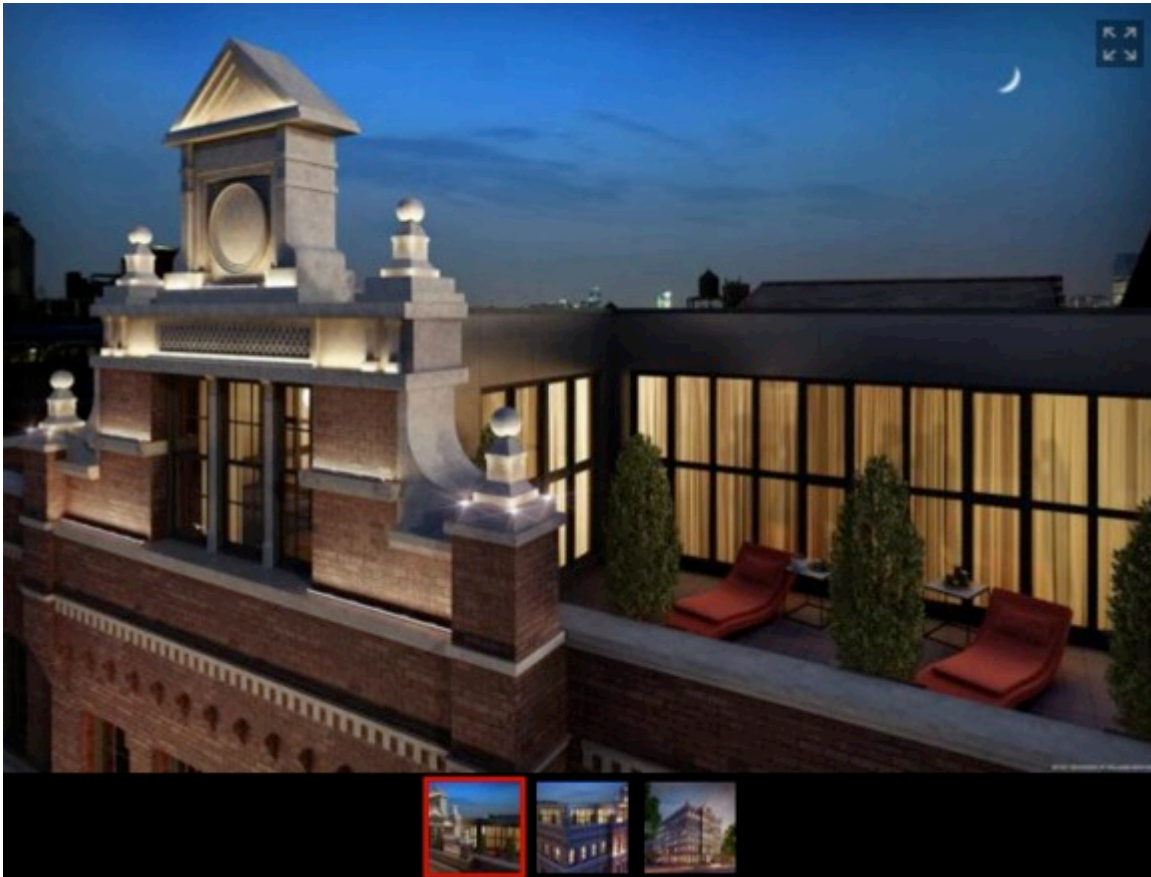

“This is the penthouse to own downtown,” said luxury broker John Gomes of Douglas Elliman, who is listing the property with Fredrik Eklund of “Million Dollar Listing New York.”

Gomes likened it to living “in the Clock Tower in DUMBO. The pediment lights up at night and becomes a beacon for the whole neighborhood.”

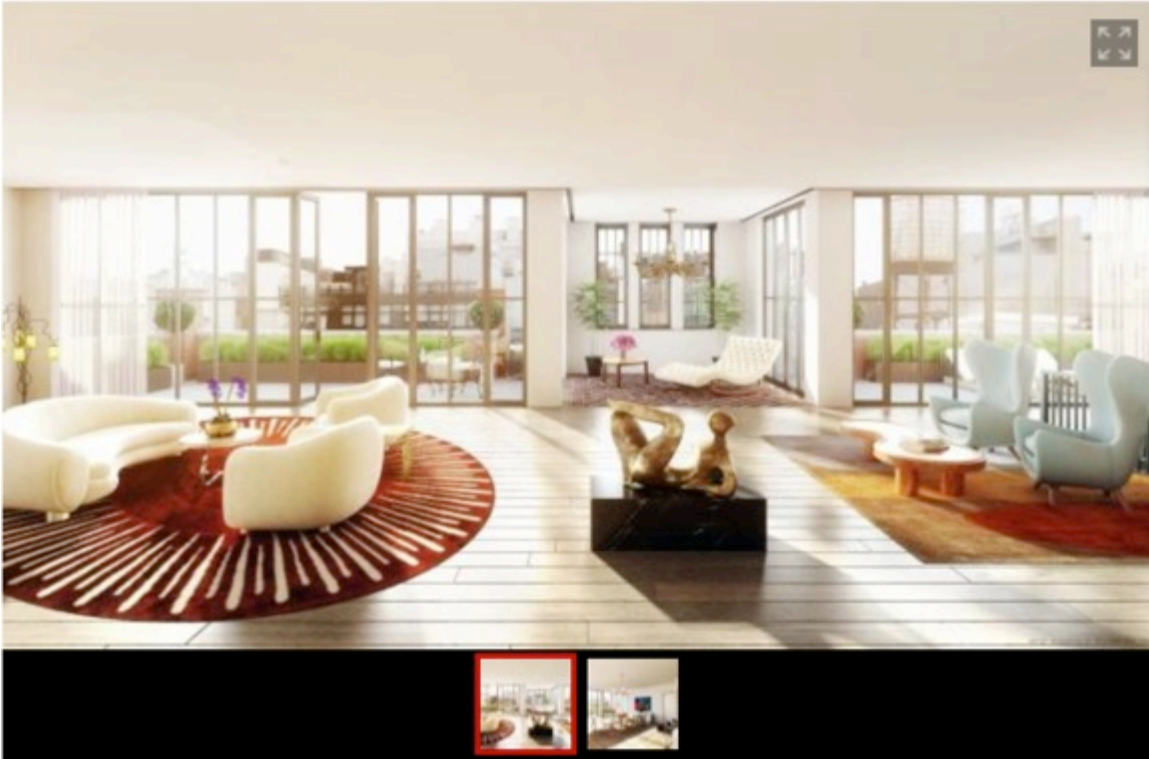

The penthouse’s upper floor, which wraps around the pediment, is dedicated to entertaining space, including a whopping 1,388 square feet of outdoor terraces. A grand staircase leads onto the lower floor, which holds four bedrooms with their own en suite bathrooms. The penthouse is the first of three highly anticipated upper-floor units about to go up for sale at the 20-unit building, which is largely sold out.

Many an A-lister has already signed on to live there, including Paramount Hotel owner Aby Rosen, celebrity talent agent Jim Berkus and art collector Alberto Mugarib, whose family owns the world’s largest collection of Andy Warhols.